

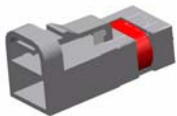

MAK12 Sealed Connectors for Fusebox

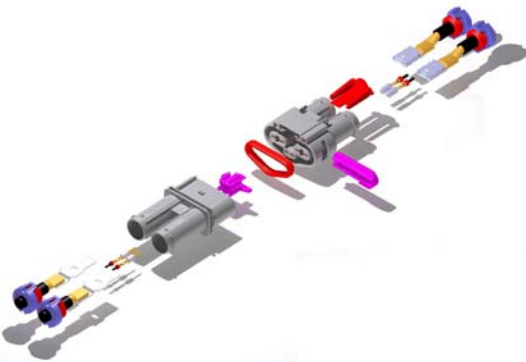

MAK12 Connector for Fusebox



MAK12 Sealed Inline

## Power Application Connectors

Lear offers a variety of connector housings for an array of power demanding applications around its *MAK8* and *MAK12* terminal series. All connectors are designed for ease in handling and operator comfort. The terminal and connector series is designed to replace typical eyelet terminal applications and offers advantages in assembly and service.

### Product Features

- Various housings for sealed and unsealed applications
- All housings with secondary terminal lock to ensure terminal position and retention
- Compact and robust designs
- Easy to handle and service

### Customer Advantages

- Plug-in solutions for power supply into power distribution boxes, on main fuse boxes, on applications with high current draw
- For use on wide array of applications with sealed and unsealed products
- Can be used on either direct or inline applications

**Status: In Production**

For further information contact:  
Lear Corporation, Terminals & Connectors Business Unit  
Schlosserstr. 4, 42899 Remscheid, GERMANY  
Phone: +49 2191 46430-0